**CONTACT**

MAIL p.wisniewski@roch.pl

WEB www.roch.pl

TEL. [+48 728 481 460](tel:+48728481460)

MADE-TO-MEASURE SEALING

OFFER

Our offer is based on an extensive stock of seals used throughout the broadly understood industry and beyond. Turned seals (made to measure) include: cylinder seals, rotary and piston seals, resistance, guide and scraper rings. All these seals are manufactured by us. We recommend that you familiarize yourself with the dedicated directories created for each group.

CYLINDER SEALS

DESCRIPTION

Cylinder seals are seals made of hard materials of high hardness (NBR, PU, FPM, VMQ, EPDM) measured on the Shore scale. They are used in systems with high pressure and temperature. Thanks to them, the cylinder is protected against external and internal leaks. It also ensures the tightness of the system and maintains the set pressure for the system.

APPLICATION

- hydraulic cylinders
- various types of pistons and rods
- high-pressure hydraulic and pneumatic linear drives



SEALING PROFILES

Our technology allows us to bore seals of various cross-sections, meeting the customer's requirements. The profiles for the cylinder seals are shown below. In order to find out about the exact parameters of the material used, please refer to the table available on the basis of seals in our offer.

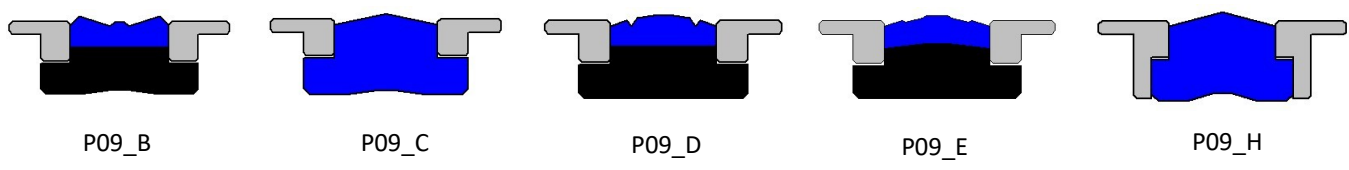
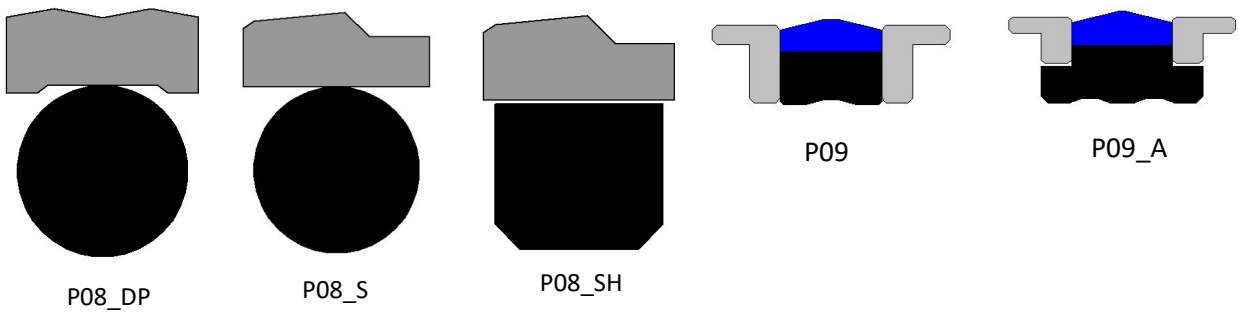
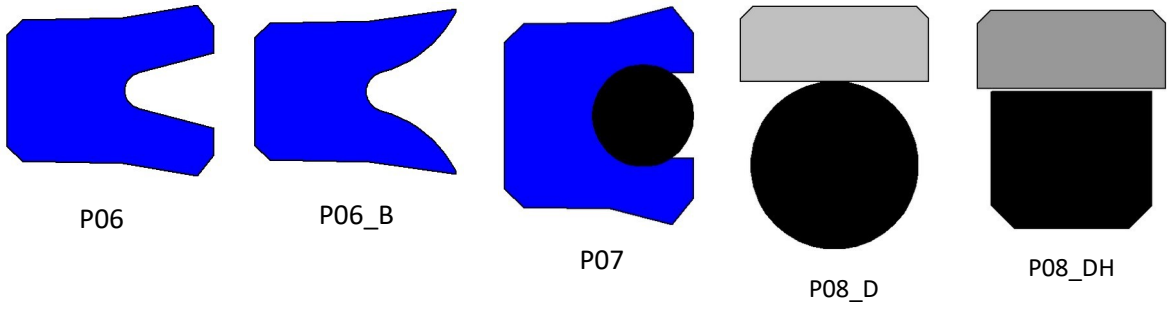
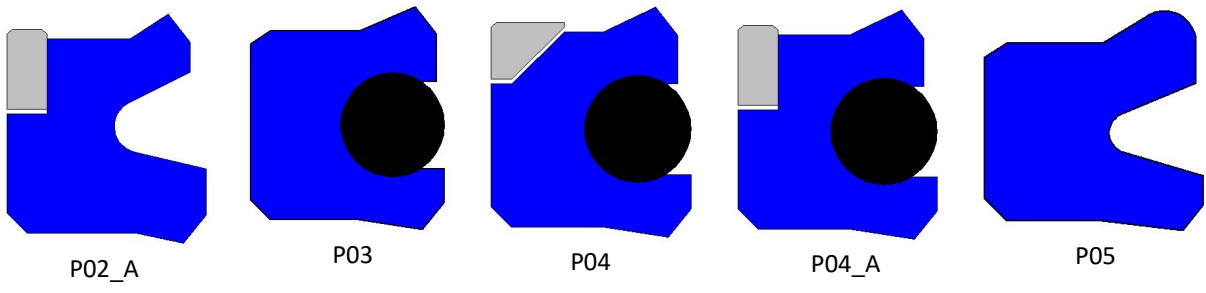
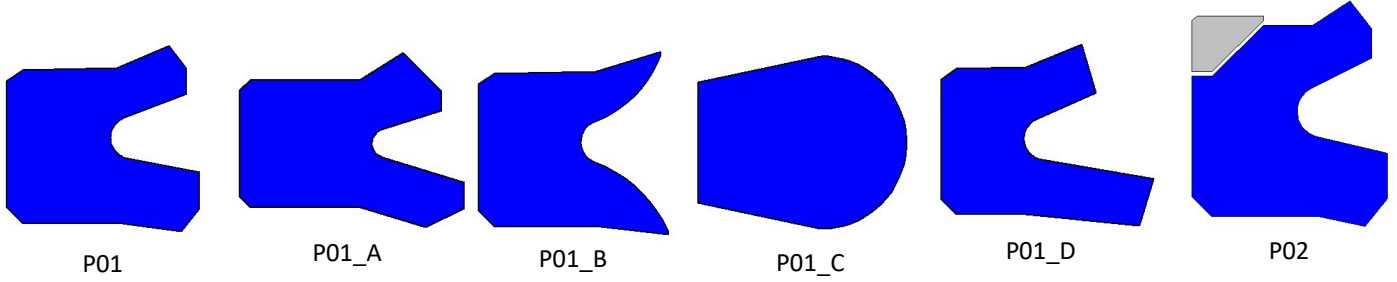



P09_LF

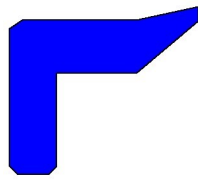

P16

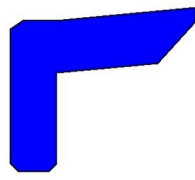

P16_A

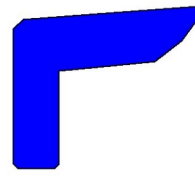

P16_B

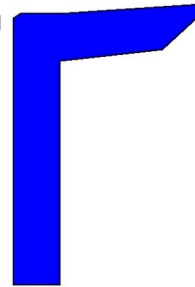

P16_FULL

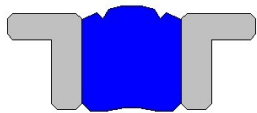

P17

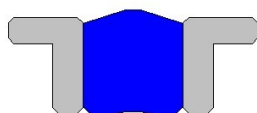

P17_A

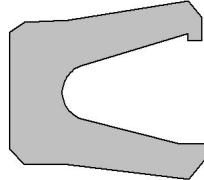

P19

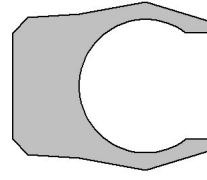

P19_B

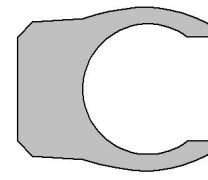

P19_C

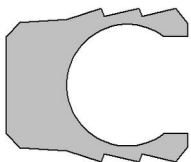

P19_D

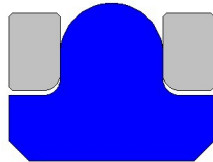

P20

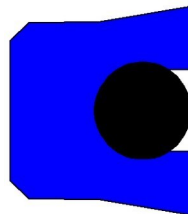

P21

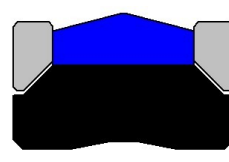

P23

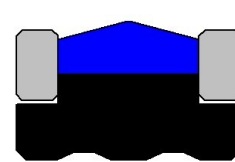

P23_A



P23_B

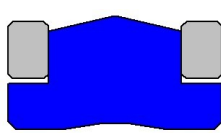

P23_C

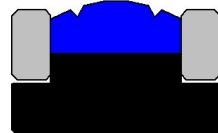

P23_D

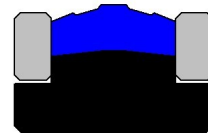

P23_E

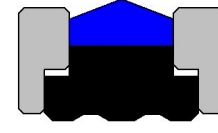

P23_H

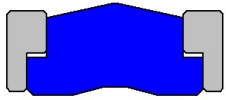

P23_HA

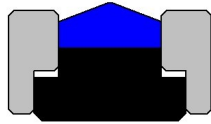

P23_HB

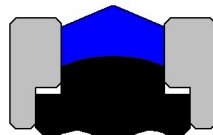

P23HC

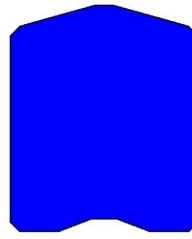

P35

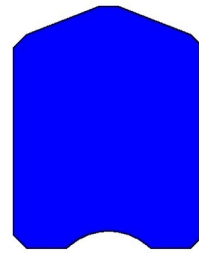

P35_A

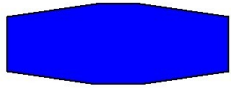

P36

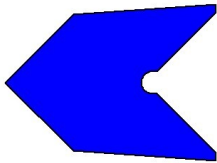

P1011

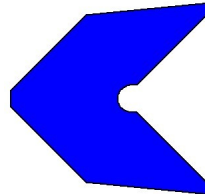

P1011_A

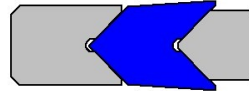

P1012

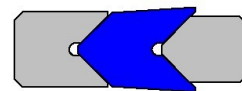

P1012_A