

## CONTACT

---

MAIL [p.wisniewski@roch.pl](mailto:p.wisniewski@roch.pl)

---

WEB [www.roch.pl](http://www.roch.pl)

---

TEL. [+48 728 481 460](tel:+48728481460)

# MADE-TO-MEASURE SEALING

## OFFER

Our offer is based on an extensive stock of seals used throughout the broadly understood industry and beyond. Turned seals (made to measure) include: cylinder seals, rotary and piston seals, resistance, guide and scraper rings. All these seals are manufactured by us. We recommend that you familiarize yourself with the dedicated directories created for each group.

# BACKING RINGS

## DESCRIPTION

**Backing rings** are seals made of hard materials of high hardness (PTFE, FKM, Viton) measured on the Shore scale. They are used in systems with high pressure and temperature. Often used to minimize the extrusion of mating O-rings.

## APPLICATION

- hydraulic cylinders
- hydraulic valves and control blocks
- high pressure hydraulic and pneumatic systems



## SEALING PROFILES

Our technology allows us to bore seals of various cross-sections, meeting the customer's requirements. The profiles for the back-up rings are shown below. In order to find out about the exact parameters of the material used, please refer to the table available on the basis of seals in our offer.

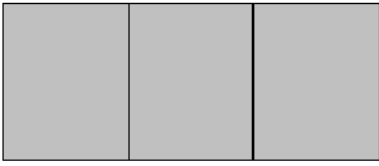

B08\_DISC

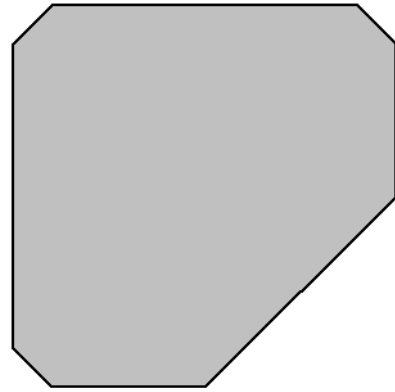

B10

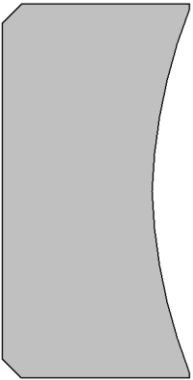

B09

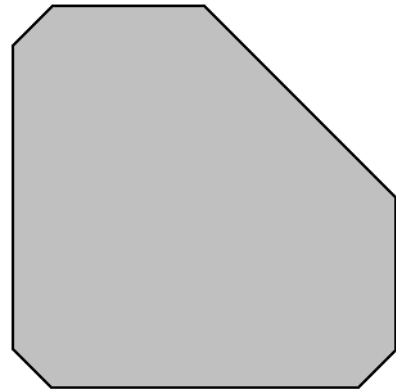

B11

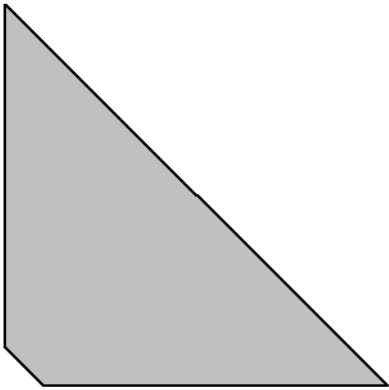

B12

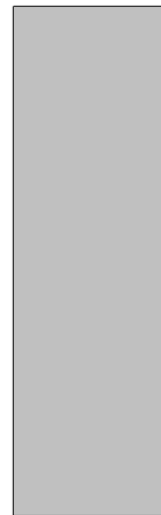

B08

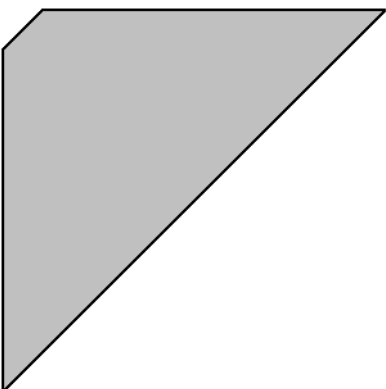

B13